



GROUP 10M EXTENDED CABLE

GROUP 10M EXTENDED CABLE

Easily customize your conference room set-up with GROUP 10m Extended Cable, a DIN cable that replaces the 5-meter cable included with Logitech GROUP. The GROUP 10m Extended Cable increases the distance from the hub to the camera or speakerphone with a single cable that can be routed through a conduit for super-clean conference room installations.

DIMENSIONS

Cable Length: 10m
Cable Thickness: 4 mm
Repeater Length: 50 mm
Repeater Thickness: 12 mm
Weight: 278 g

PACKAGE CONTENTS

One 10m DIN Cable
Velcro Cable Management Straps

WARRANTY

2-Year Limited Hardware Warranty

SYSTEM REQUIREMENTS

Logitech GROUP

TECHNICAL SPECIFICATIONS

Connection Type

Mini-DIN-6

Compliance

Emissions: FCC Class (A), CE
Regulatory: RoHS
Flammability: UL/CSA Type CM, VW-1

GROUP 10M EXTENDED CABLE

Setup Guide | 3 Options

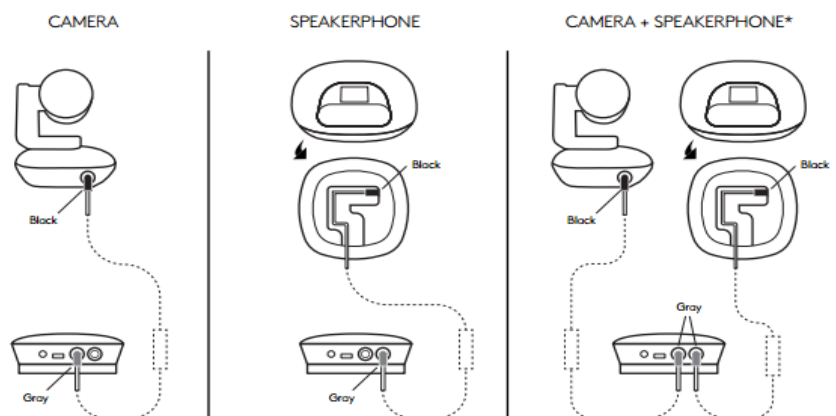

www.logitech.com/support/GROUP-Extended-Cable



*Requires purchase of two GROUP 10m Extended Cables